

A



- 1.....VTEK1/VTEK2
- 2.....auto body sheet
- 3.....lining disk (provided)
- 4.....fixing screw nut (provided)
- 5.....fixing screw (provided)

B

cut-out:
102mm (diameter)

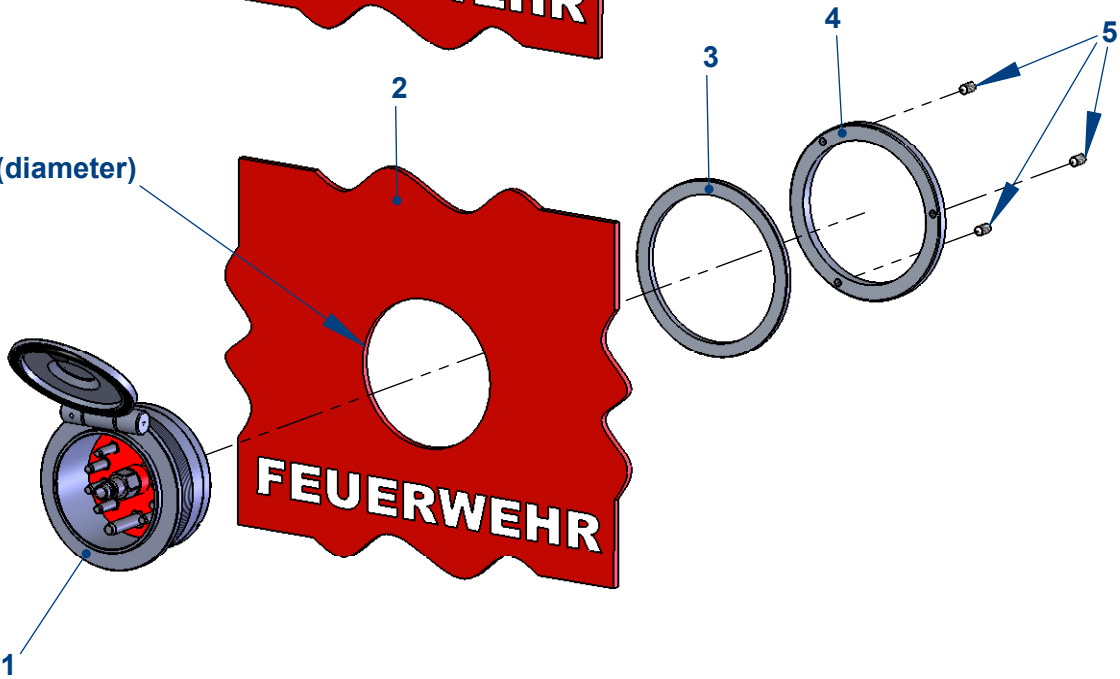

C

mounting orientation:

D

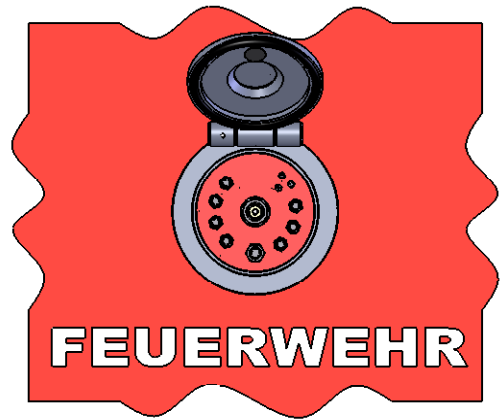
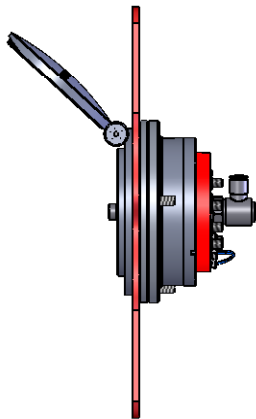

E

UNLESS OTHERWISE SPECIFIED:
DIMENSIONS ARE IN MILLIMETERS
SURFACE FINISH:
TOLERANCES:
LINEAR:
ANGULAR:

FINISH:

DEBUR AND
BREAK SHARP
EDGES

DO NOT SCALE DRAWING

REVISION

Ing. Anton Schottleitner GmbH

	NAME	SIGNATURE	DATE	
DRAWN	Schauer A.		06.02.2008	
CHKD				
APPV'D				
MFG				
Q.A				
				MATERIAL:
				WEIGHT:

Projekt:	VTEK
Titel:	installation "VTEK1/VTEK2"
Beschreibung:	Manual
Maßstab: 1:5	Blatt 1 / 4

A4